

CANDY 'N' MINT BANGLE



INSTRUCTION BRILLIANT BRIOLETTE CANDY 'N' MINT BANGLE



SWAROVSKI ELEMENTS

Supplies & Tools

Article	Product Group	Article No.	Amount	Size	Color	Color Code	Supplies
	Beads	5040	2 pcs.	12 mm	Crystal Golden Shadow	001 GSHA	1x Bangle round, gold, 4 mm 6x Head pin, gold, 1.5 mm 1x Jump ring, gold, 4 mm
	Beads	5040	2 pcs.	18 mm	Crystal Golden Shadow	001 GSHA	
	Crystal Pearls	5811	1 pc.	16 mm	Crystal Jade Pearl	001 715	Tools Flat nose pliers Round nose pliers Side cutter
	Crystal Pearls	5840	1 pc.	14 mm	Crystal Ivory Pearl	001 708	

Level of design: BEGINNER

STEP 1

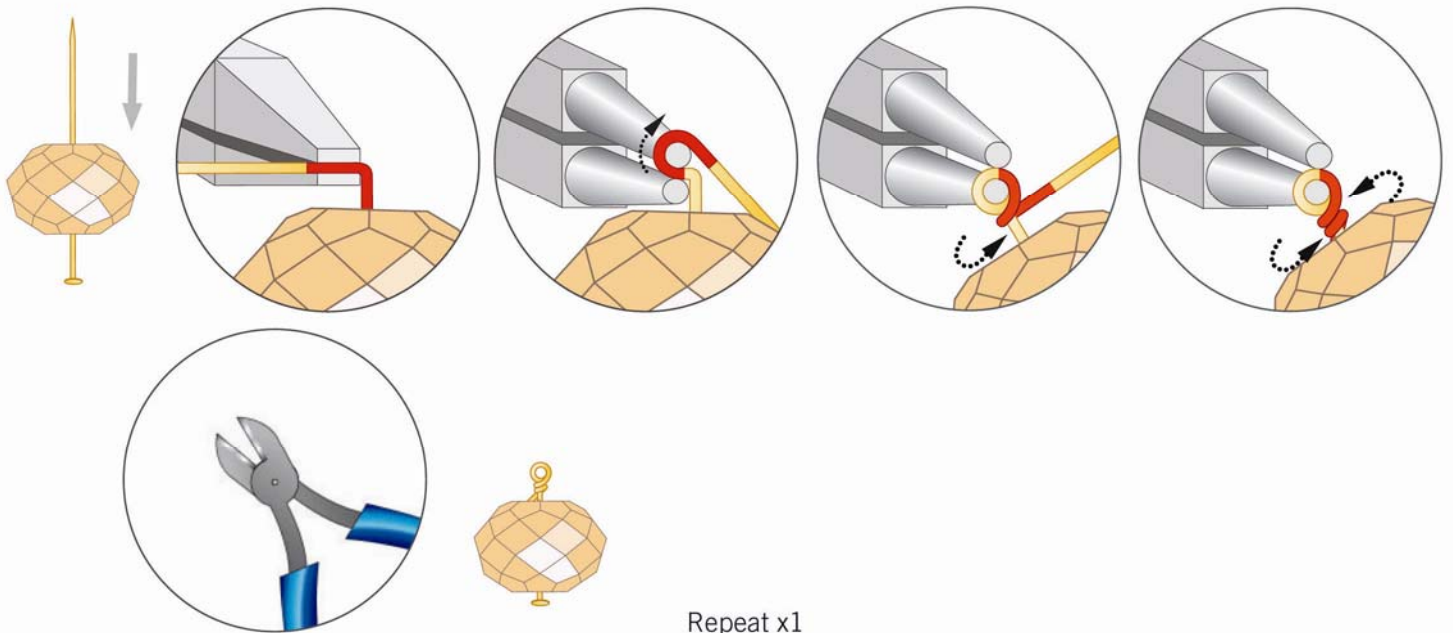

STEP 2

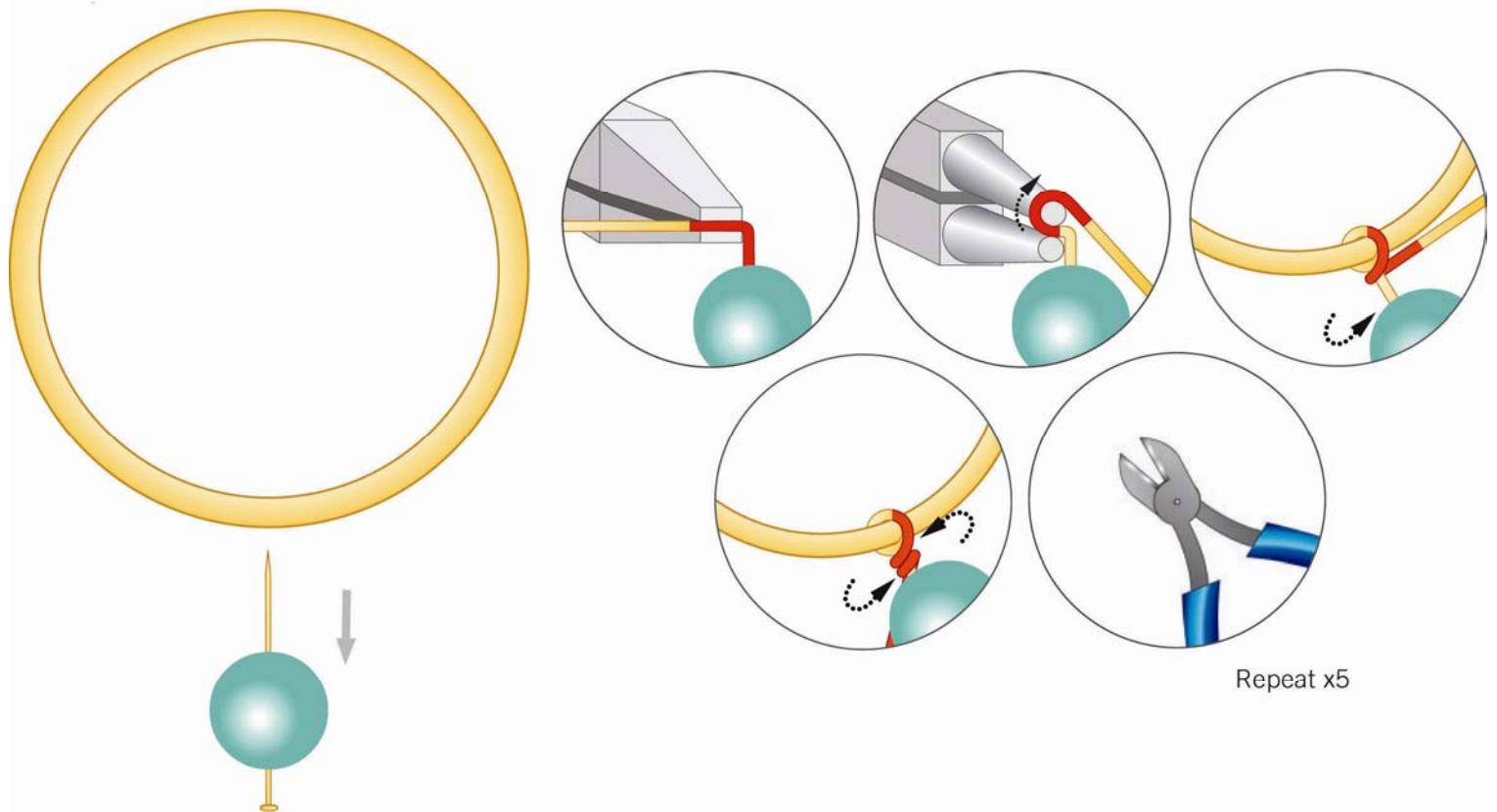

STEP 3



- STEP 1: Slide one Swarovski Bead art. 5040 12 mm Crystal Golden Shadow onto a headpin and turn a loop close to the top of the Bead using flat and round nose pliers, as shown in the illustration. Repeat this step for the other 12 mm & one of the Bead art. 5040 18mm and Crystal Pearl art. 5840 14mm Crystal Ivory Pearl.
- STEP 2: Slide a Crystal Pearl art. 5811 16 mm Crystal Jade Pearl onto a headpin and wire wrap it around the bangle using flat and round nose pliers. Repeat this step for the other Swarovski Bead art. 5040 18mm Crystal Golden Shadow.
- STEP 3: Open two 6mm jump rings and attach two of the looped head pins on each. Close each of the jump rings around the bangle. Other color variations are made in the same manner.